

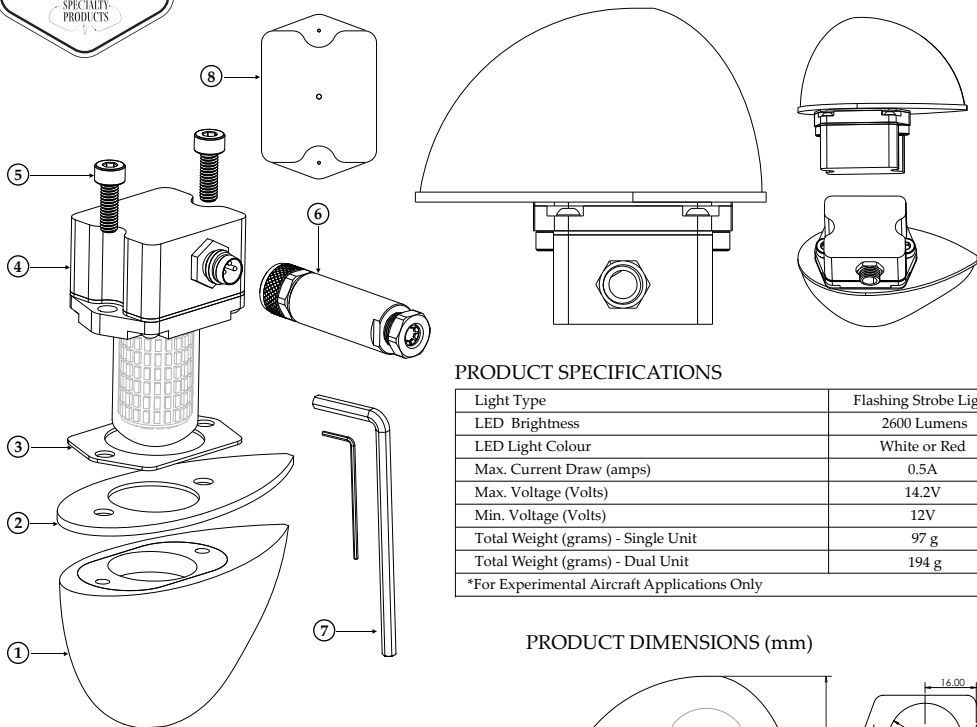

H9W AERODYNAMIC LED STROBE LIGHT



PRODUCT SPECIFICATIONS

Light Type	Flashing Strobe Light
LED Brightness	2600 Lumens
LED Light Colour	White or Red
Max. Current Draw (amps)	0.5A
Max. Voltage (Volts)	14.2V
Min. Voltage (Volts)	12V
Total Weight (grams) - Single Unit	97 g
Total Weight (grams) - Dual Unit	194 g
*For Experimental Aircraft Applications Only	

PRODUCT DIMENSIONS (mm)

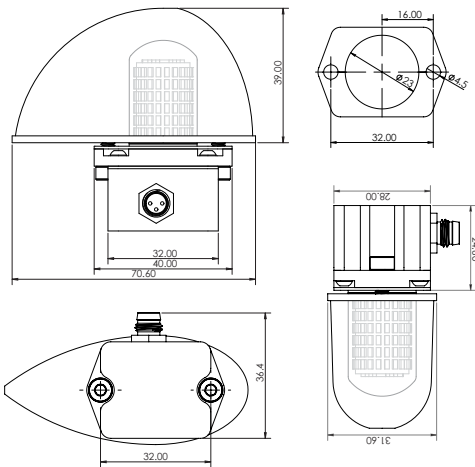

SINGLE PACK	DUAL PACK
1 Piece	2 Pieces
1 Piece	2 Pieces
1 Piece	2 Pieces
1 Piece	2 Pieces
2 Pieces	4 Pieces
1 Piece	2 Pieces
1 Piece	1 Pieces
1 Piece	2 Pieces

INCLUDED COMPONENTS

- ① Translucent polycarbonate lens; 6061 aluminum holder plate.
- ② TPU rubber outer gasket.
- ③ TPU rubber inner gasket.
- ④ 2600 Lumen LED module; 6061 aluminum holder case;
- ⑤ Stainless steel M4*12mm socket head cap screw.
- ⑥ M8 Nano connector.
- ⑦ 0.9mm and 3mm hex key.
- ⑧ Drilling guide template.

COMPONENTS REQUIRED TO COMPLETE INSTALLATION

- 1. On-off switch.
- 2. Electrical wire - recommend 20AWG or thicker.
- 3. Circuit breaker - recommend Klaxon 7277-1 or equivalent 1 amp circuit breaker.



H9W AERODYNAMIC LED STROBE LIGHT

INSTALLATION INSTRUCTIONS

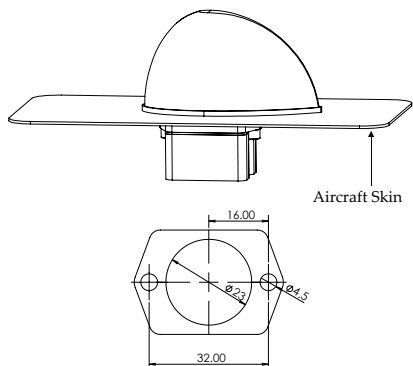

Aircraft Skin

1. Choose a suitable location for installation of the strobe light. Remember that the back of the strobe light must be accessible for its installation. Room should be reserved around the unit for wiring to run without tight bends.
2. At your chosen location mark and drill the three required holes using the provided drill guide sticker. Two 4.5mm (or 11/64 in) holes, and one 23mm hole are required.
3. Place the inner gasket, then install the LED light unit through the hole. The LED unit can be rotated by 180 degrees depending on which side the connector works best for your installation. The outside gasket and the lens unit can now be placed on the outside and attached with the two provided M4*12 socket head cap screws. These screws can be replaced with longer ones if necessitated by aircraft skin thickness. It is recommended to use loctite on the mounting screws.
4. Wiring:
Refer to the **wiring diagram** for a typical system installation.

Single Light Installation:

Connect to switched 12V power via a 1-amp circuit breaker, and ground.

Dual Light Installation:

Light 1: Requires 12V power, ground, and a sync connection to Light 2.

Light 2: Requires 12V power and the sync connection.

The sync connection allows the two lights to flash in synchronization.

M8 Nano Connector

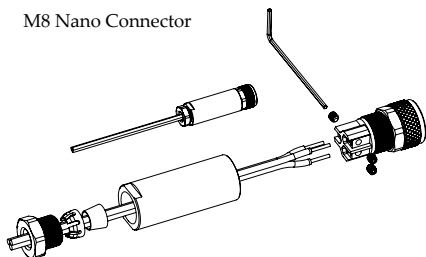

The included M8 Nano Connector uses screw terminals, a 0.9 mm allen key is included.

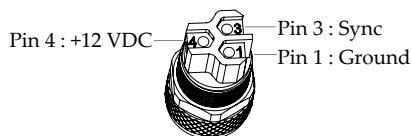

A 90-degree version of the M8 Nano Connector is available for purchase separately for installations in tighter spaces.
(Not included in standard package)



Wiring Diagram (Typical installation)

Single light installation

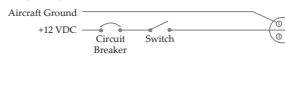

Dual light installation

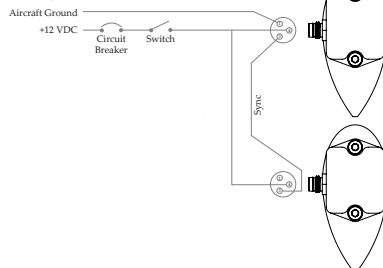

Disclaimer

This product is Non-TSO'd and uncertified. It is NOT approved for use on certified aircraft. It is up to the user to determine the airworthiness of their specific application.

Minimum 20 AWG wire is recommended for all connections.

Please do not hesitate to contact H9W with any questions regarding your installation.
info@h9w-aviation.com